

8M HTD® Pulleys - Taper Bushed



8 mm HTD® x 20, 30, 50 and 85 mm Belt Widths

Part No. TL80-8M-20

- TL = Taper Bushed Version
- 80 = No. of Teeth
- 8M = Pitch (5, 8 and 14mm)
- 20 = Width of belt (20, 30, 50 and 85)



Models Available

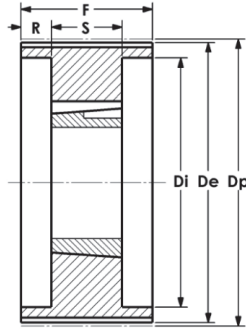

Fig 4

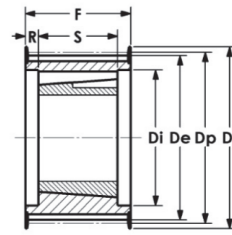

Fig 4F

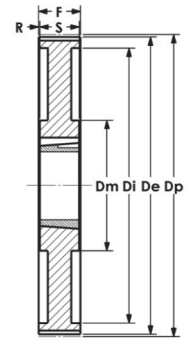

Fig 9A

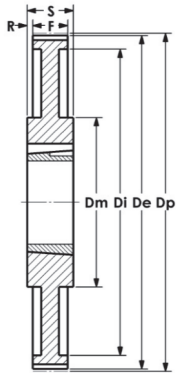

Fig 7A

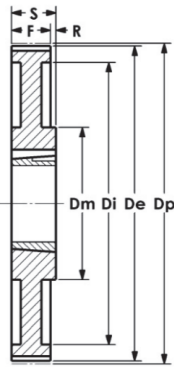

Fig 8A

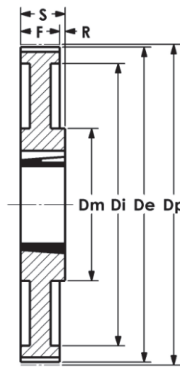

Fig 8W

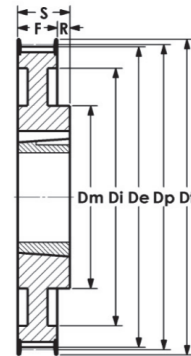

Fig 8WF

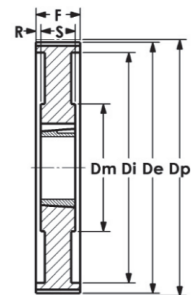

Fig 9W

Dimensions in mm

Part No.	Bushing	Teeth	Belt Width	Material	Figure	Dp	De	Df	Dm	Di	F	S	R	Wt. kg
TL72-8M-20	2012	72	20	GG	8WF	183.35	181.97	192.0	110	158	28	32	4.0	3.30
TL72-8M-30	2517		30	GG	8WF	183.35	181.97	192.0	125	158	38	45	7.0	4.30
TL72-8M-50	2517		50	GG	4F	183.35	181.97	192.0	125	158	60	45	7.5	6.70
TL72-8M-85	3020		85	GG	4F	183.35	181.97	192.0	—	158	95	51	22.0	8.00
TL80-8M-20	2012	80	20	GG	8W	203.72	202.35	—	110	180	28	32	4.0	3.50
TL80-8M-30	2517		30	GG	8W	203.72	202.35	—	125	180	38	45	7.0	4.60
TL80-8M-50	3020		50	GG	4	203.72	202.35	—	—	180	60	51	4.5	8.80
TL80-8M-85	3020		85	GG	4	203.72	202.35	—	—	180	95	51	22.0	10.00
TL90-8M-20	2012	90	20	GG	8A	229.18	227.81	—	110	204	28	32	4.0	3.65
TL90-8M-30	2517		30	GG	8A	229.18	227.81	—	125	204	38	45	7.0	5.00
TL90-8M-50	3020		50	GG	9W	229.18	227.81	—	170	204	60	51	4.5	10.00
TL90-8M-85	3020		85	GG	9W	229.18	227.81	—	170	204	95	51	22.0	10.80
TL112-8M-30	2517	112	30	GG	8A	285.21	283.83	—	125	260	38	45	7.0	6.20
TL112-8M-50	3020		50	GG	9W	285.21	283.83	—	170	260	60	51	4.5	12.00
TL112-8M-85	3020		85	GG	9W	285.21	283.83	—	170	260	95	51	22.0	15.00
TL144-8M-30	2517	144	30	GG	8A	366.69	365.32	—	125	341	38	45	7.0	9.00
TL144-8M-50	3020		50	GG	9A	366.69	365.32	—	170	341	60	51	4.5	15.20
TL144-8M-85	3525		85	GG	9A	366.69	365.32	—	190	341	95	65	15.0	20.00
TL168-8M-50	3525	168	50	GG	7A	427.81	426.44	—	190	402	60	65	2.5	16.40
TL168-8M-85	3525		85	GG	9A	427.81	426.44	—	190	402	95	65	15.0	23.00
TL192-8M-50	3525	192	50	GG	7A	488.92	487.55	—	190	460	60	65	2.5	21.80
TL192-8M-85	3525		85	GG	9A	488.92	487.55	—	190	460	95	65	15.0	28.50

Note: GG = Cast Iron.