

# Metric Timing Pulleys



## T Series - 10 mm Pitch Aluminum, Pilot Bore

Part No: 31T10/25-2

31 = Length thru Bore

T10 = Tooth Profile and Pitch

25 = Number of Teeth

2 = Number of Flanges



Models Available

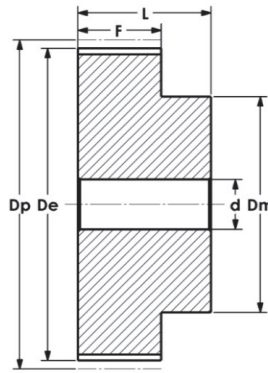

Type 6

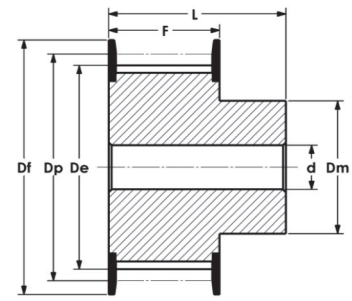

Type 6F

### T-10 mm Pitch x 16 mm Belt Width

Dimensions in mm

Part No.	Part Code	Teeth	Type	Belt Width	Material	Dp	De	Df	Dm	F	L	d	Wt. kg
31T10/12-2	12T10-31	12	6F	16	AL	38.35	36.35	42	28	21	31	6	0.076
31T10/14-2	14T10-31	14	6F	16	AL	44.72	42.70	48	32	21	31	8	0.104
31T10/15-2	15T10-31	15	6F	16	AL	47.90	45.90	51	32	21	31	8	0.116
31T10/16-2	16T10-31	16	6F	16	AL	51.05	49.05	54	35	21	31	8	0.134
31T10/18-2	18T10-31	18	6F	16	AL	57.45	55.45	60	40	21	31	8	0.167
31T10/19-2	19T10-31	19	6F	16	AL	60.60	58.60	66	44	21	31	8	0.184
31T10/20-2	20T10-31	20	6F	16	AL	63.80	61.80	66	46	21	31	8	0.208
31T10/22-2	22T10-31	22	6F	16	AL	70.15	68.15	75	52	21	31	8	0.253
31T10/24-2	24T10-31	24	6F	16	AL	76.55	74.55	83	58	21	31	8	0.288
31T10/25-2	25T10-31	25	6F	16	AL	79.70	77.70	83	60	21	31	8	0.310
31T10/26-2	26T10-31	26	6F	16	AL	82.90	80.90	87	60	21	31	8	0.357
31T10/27-2	27T10-31	27	6F	16	AL	86.10	84.10	91	60	21	31	8	0.364
31T10/28-2	28T10-31	28	6F	16	AL	89.25	87.25	93	60	21	31	8	0.401
31T10/30-2	30T10-31	30	6F	16	AL	95.65	93.65	97	60	21	31	8	0.441
31T10/32-2	32T10-31	32	6F	16	AL	102.00	100.00	106	65	21	31	10	0.493
31T10/36-2	36T10-31	36	6F	16	AL	114.75	112.75	120	70	21	31	10	0.623
31T10/40-2	40T10-31	40	6F	16	AL	127.45	125.45	131	80	21	31	10	0.767
31T10/44-0	44T10-31	44	6	16	AL	140.20	138.20	—	88	21	31	10	0.993
31T10/48-0	48T10-31	48	6	16	AL	152.95	150.95	—	95	21	31	16	1.090
31T10/60-0	60T10-31	60	6	16	AL	191.10	189.10	—	110	21	31	16	1.701

### T-10 mm Pitch x 25 mm Belt Width

Part No.	Part Code	Teeth	Type	Belt Width	Material	Dp	De	Df	Dm	F	L	d	Wt. kg
40T10/12-2	12T10-40	12	6F	25	AL	38.35	36.35	42	28	30	40	6	0.076
40T10/14-2	14T10-40	14	6F	25	AL	44.70	42.70	48	32	30	40	8	0.104
40T10/15-2	15T10-40	15	6F	25	AL	47.90	45.90	51	32	30	40	8	0.116
40T10/16-2	16T10-40	16	6F	25	AL	51.05	49.05	54	35	30	40	8	0.134
40T10/18-2	18T10-40	18	6F	25	AL	57.45	55.45	60	40	30	40	8	0.167
40T10/19-2	19T10-40	19	6F	25	AL	60.60	58.60	66	44	30	40	8	0.184
40T10/20-2	20T10-40	20	6F	25	AL	63.80	61.80	66	46	30	40	8	0.208
40T10/22-2	22T10-40	22	6F	25	AL	70.15	68.15	75	52	30	40	8	0.253
40T10/24-2	24T10-40	24	6F	25	AL	76.55	74.55	83	58	30	40	8	0.288
40T10/25-2	25T10-40	25	6F	25	AL	79.70	77.70	83	60	30	40	8	0.310
40T10/26-2	26T10-40	26	6F	25	AL	82.90	80.90	87	60	30	40	8	0.357
40T10/27-2	27T10-40	27	6F	25	AL	86.10	84.10	91	60	30	40	8	0.364
40T10/28-2	28T10-40	28	6F	25	AL	89.25	87.25	93	60	30	40	8	0.401
40T10/30-2	30T10-40	30	6F	25	AL	95.65	93.65	97	60	30	40	8	0.441
40T10/32-2	32T10-40	32	6F	25	AL	102.00	100.00	106	65	30	40	10	0.493
40T10/36-2	36T10-40	36	6F	25	AL	114.75	112.75	120	70	30	40	10	0.623
40T10/40-2	40T10-40	40	6F	25	AL	127.45	125.45	131	80	30	40	10	0.767
40T10/44-0	44T10-40	44	6	25	AL	140.20	138.20	—	88	30	40	10	0.993
40T10/48-0	48T10-40	48	6	25	AL	152.95	150.95	—	95	30	40	16	1.090
40T10/60-0	60T10-40	60	6	25	AL	191.10	189.10	—	110	30	40	16	1.701

Note: Finished Bore & Keyway available on request.