

Synchronous Pulleys - Taper Bushed



H - Series - 1/2" Pitch x 1", 1 1/2", 2" and 3" Belt Widths

Part No: 28H 100T-1610

28 = No. of Teeth

H = Pitch (XL = 1/5", L = 3/8", H = 1/2")

100 = Width of Belt (Inches)

N = Pilot Bore, T = Taper Bore

1610 = Bushing Size



Models Available

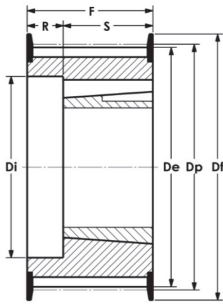

Fig 5F

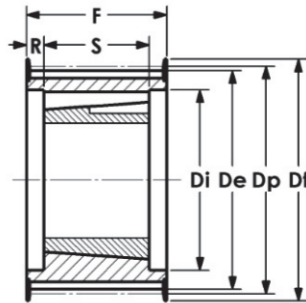

Fig 4F

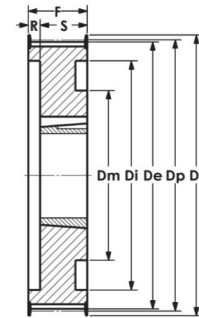

Fig 5WF

Dimensions in inches

Part No.	Bushing	Teeth	Belt Width	Material	Figure	Dp	De	Df	Dm	Di	F	S	R	Wt. kg
25H100T	1610	25	1.0	GG	5F	3.979	3.92	4.17	—	3.11	1.26	0.98	0.28	1.0
25H150T	1610		1.5	GG	5F	3.979	3.92	4.17	—	3.07	1.77	0.98	0.79	1.2
25H200T	1610		2.0	GG	5F	3.979	3.92	4.17	—	3.07	2.28	0.98	1.30	1.5
25H300T	1615		3.0	GG	4F	3.979	3.92	4.17	—	3.11	3.31	1.50	0.91	2.0
26H100T	1610	26	1.0	GG	5F	4.138	4.08	4.37	—	3.27	1.26	0.98	0.28	1.2
26H150T	1610		1.5	GG	5F	4.138	4.08	4.37	—	3.23	1.77	0.98	0.79	1.4
26H200T	1610		2.0	GG	5F	4.138	4.08	4.37	—	3.23	2.28	0.98	1.30	1.8
26H300T	1615		3.0	GG	4F	4.138	4.08	4.37	—	3.27	3.31	1.50	0.91	2.7
27H100T	1610	27	1.0	GG	5F	4.297	4.24	4.53	—	3.43	1.26	0.98	0.28	1.3
27H150T	1610		1.5	GG	5F	4.297	4.24	4.53	—	3.43	1.77	0.98	0.79	1.6
27H200T	1610		2.0	GG	5F	4.297	4.24	4.53	—	3.43	2.28	0.98	1.30	1.9
27H300T	2012		3.0	GG	4F	4.297	4.24	4.53	—	3.43	3.31	1.26	1.02	3.0
28H100T	1610	28	1.0	GG	5F	4.456	4.40	4.69	—	3.58	1.26	0.98	0.28	1.5
28H150T	1610		1.5	GG	5F	4.456	4.40	4.69	—	3.58	1.77	0.98	0.79	1.8
28H200T	1610		2.0	GG	5F	4.456	4.40	4.69	—	3.58	2.28	0.98	1.30	1.9
28H300T	2012		3.0	GG	4F	4.456	4.40	4.69	—	3.58	3.31	1.26	1.02	2.4
30H100T	1610	30	1.0	GG	5F	4.775	4.72	5.00	—	3.90	1.26	0.98	0.28	1.7
30H150T	1610		1.5	GG	5F	4.775	4.72	5.00	—	3.90	1.77	0.98	0.79	2.0
30H200T	1610		2.0	GG	5F	4.775	4.72	5.00	—	3.90	2.28	0.98	1.30	2.3
30H300T	2012		3.0	GG	4F	4.775	4.72	5.00	—	3.90	3.31	1.26	1.03	2.9
32H100T	1610	32	1.0	GG	5WF	5.093	5.04	5.31	3.62	4.25	1.26	0.98	0.28	2.0
32H150T	1610		1.5	GG	5WF	5.093	5.04	5.31	3.62	4.25	1.77	0.98	0.79	2.3
32H200T	2012		2.0	GG	5F	5.093	5.04	5.31	—	4.21	2.28	1.26	1.02	3.0
32H300T*	2517		3.0	GG	4F	5.093	5.04	5.31	—	4.21	3.31	1.77	0.77	3.3
36H100T	1610	36	1.0	GG	5WF	5.730	5.68	5.98	3.62	4.88	1.26	0.98	0.28	2.7
36H150T	1610		1.5	GG	5WF	5.730	5.68	5.98	3.62	4.88	1.77	0.98	0.79	3.1
36H200T	2012		2.0	GG	5WF	5.730	5.68	5.98	4.02	4.88	2.28	1.26	1.02	3.0
36H300T*	2517		3.0	GG	4F	5.730	5.68	5.98	—	4.88	3.31	1.77	0.77	4.5

Note: Pilot bore available on request. GG = Cast Iron. * Requires TL Bushing with BSW screws.