

Metric Sprockets



ISO 20B-2, 20B-3 Hub Type B

DIN 8187/ISO R 606

Chain Size: 20B-2 (1-1/4" x 3/4")

Pitch: 31.75 mm (1-1/4")

Roller Width: 19.56 mm

Roller Dia.: 19.05 mm

Material: Steel C45

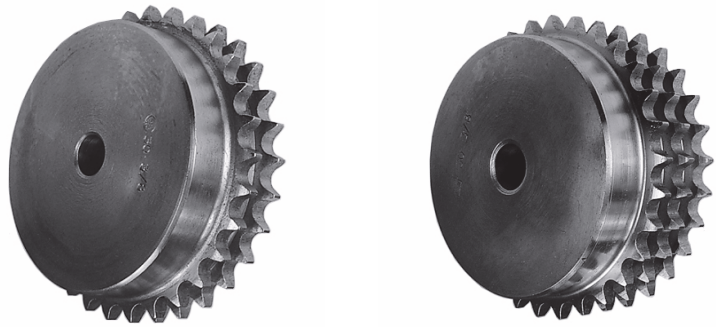

Chain Size: 20B-2

Spkt. Width: 54.6 mm (bf₂)

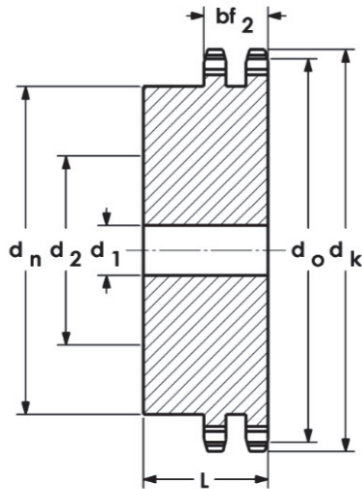

Models Available

Part No.	Teeth	d _o mm	d _k mm	d _n mm	d ₁ mm	d ₂ mm	L mm	Wt. kg
20B-2-10B	10	102.7	118	70	20	40	75	2.8
20B-2-11B	11	112.6	127.8	77	20	47	80	3.9
20B-2-12B	12	122.7	138	88	20	54	80	5.0
20B-2-13B	13	132.7	148	98	20	61	80	6.3
20B-2-14B	14	142.7	158	108	20	68	80	7.2
20B-2-15B	15	152.7	168	118	20	75	80	8.2
20B-2-16B	16	162.7	178	120	25	75	80	9.0
20B-2-17B	17	172.8	188	120	25	75	80	10.0
20B-2-18B	18	182.8	198	120	25	75	80	11.2
20B-2-19B	19	192.9	208	120	25	75	80	12.6
20B-2-20B	20	202.9	218	120	25	75	80	14.2

Larger sizes with welded hub on request.

Chain Size: 20B-3

Spkt. Width: 91 mm (bf₃)

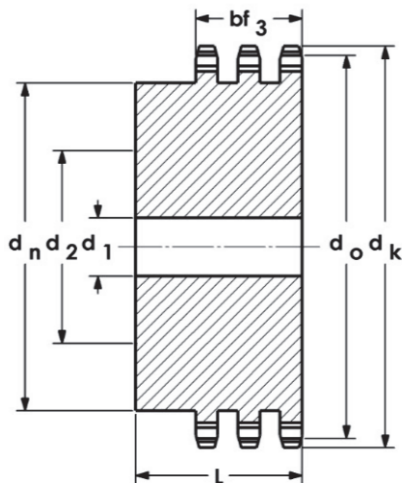

Part No.	Teeth	d _o mm	d _k mm	d _n mm	d ₁ mm	d ₂ mm	L mm	Wt. kg
20B-3-10B	10	102.7	118	70	20	40	110	4.6
20B-3-11B	11	112.6	127.8	77	20	47	115	6.0
20B-3-12B	12	122.7	138	88	20	54	115	7.4
20B-3-13B	13	132.7	148	98	20	61	115	8.9
20B-3-14B	14	142.7	158	108	20	68	115	10.5
20B-3-15B	15	152.7	168	118	20	75	115	12.4
20B-3-16B	16	162.7	178	120	25	75	115	13.9
20B-3-17B	17	172.8	188	120	25	75	115	15.1
20B-3-18B	18	182.8	198	120	25	75	115	16.8
20B-3-19B	19	192.9	208	120	25	75	115	19.1
20B-3-20B	20	202.9	218	120	25	75	115	22.4

Larger sizes with welded hub on request.