

Accumulator Chain

For Automated Conveying Systems

The temperature range for Accumulator Chain is -30° to 100°C for Steel Rollers and -10° to 60°C for Plastic Conveyor Rollers. Sprockets spacing and chain guide details are shown at right.



Size	B ₃	H
513 SF	20.8	15.0
513 SFK	20.8	15.0
D 513 SF	40.5	15.0
548 SF	33.0	20.0
D 548 SF	66.0	20.0
722 SF	20.8	15.0
728	33.0	27.0

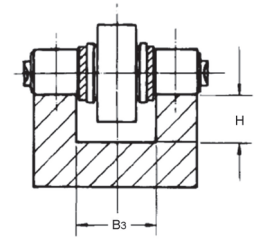

Design D

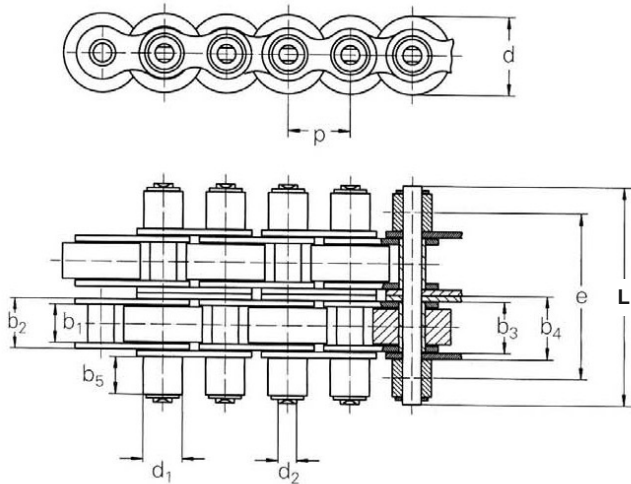

Design T

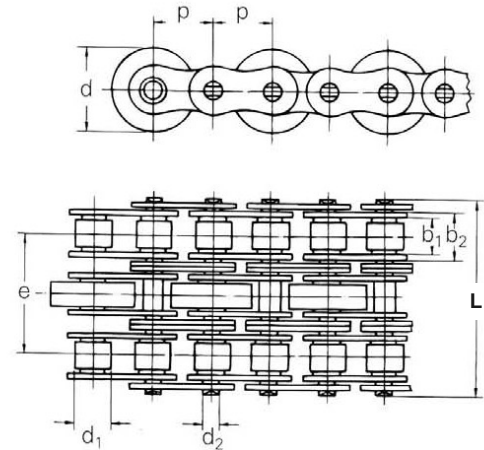

Standard

Dimensions		Conveyor Rollers						Minimum tensile strength F _B min kN	Maximum load per m conveyor chain with 10 m conveyor length	
Roller 3		Designation for material			Roller Diameter Options				Steel Roller kg	Plastic Roller kg
L max mm	b ₅ max mm	Steel	Plastic PA 6.6	Nylon Vestamid	Roller 1 d	Roller 2 d	Roller 3 d			
40.0	7.5	SF	SFK	SFV	24.0	26.0	28.0	29.00	300	260
—	—	SF	SFK	SFV	38.5	—	—	60.00	600	500
—	—	SF	SFK	SFV	24.0	26.0	28.0	29.00	300	260
—	—	SF	SFK	SFV	38.5	40.0	50.0	60.00	600	500
—	—	SF	SFK	SFV	24.0	26.0	28.0	57.80	600	520
—	—	SF	SFK	SFV	38.5	—	—	120.00	1200	1000
—	—	SF	SFK	SFV	9.2	15.0	—	16.80	100	100
—	—	SF	SFK	SFV	24.0	26.0	28.0	60.00	600	260
—	—	SF	SFK	SFV	38.5	—	—	120.00	1200	500

Stainless Steel

40.0	75.0	SF RF	SFK RF	SFV RF	24.0	26.0	28.0	18.50	200	200
—	—	SF RF	SFK RF	SFV RV	38.5	—	—	40.00	300	300
—	—	SF RF	SFK RF	SFV RV	24.0	26.0	28.0	18.50	200	200
—	—	SF RF	SFK RF	SFV RV	38.5	40.0	50.0	40.00	300	300
—	—	SF RF	SFK RF	SFV RV	24.0	26.0	28.0	31.45	400	400
—	—	SF RF	SFK RF	SFV RV	38.5	—	—	68.00	600	600