

Metric Lock Washers

MB Series

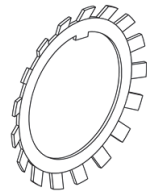

Models Available

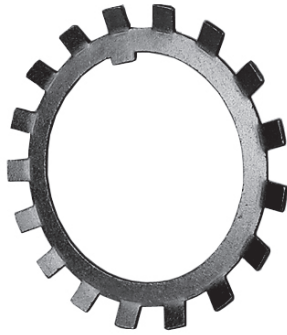
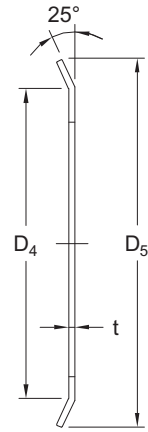
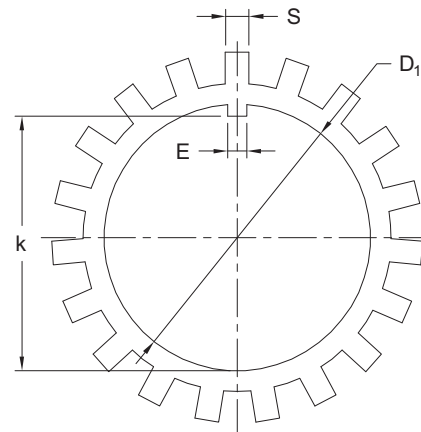

Dimensions in mm

Part No.	D ₁	k	E	t	S	D ₄	D ₅	Tangs	Use with Lock Nut	Wt. kg/1000 Pcs
MB0	10	8.5	3	1	3	13	21	9	KM0	0.13
MB1	12	10.5	3	1	3	17	25	9	KM1	0.20
MB2	15	13.5	4	1	4	21	28	13	KM2	0.26
MB3	17	15.5	4	1	4	24	32	13	KM3	0.32
MB4	20	18.5	4	1	4	26	36	13	KM4	0.35
MB5	25	23	5	1.2	5	32	42	13	KM5	0.64
MB6	30	27.5	5	1.2	5	38	49	13	KM6	0.78
MB7	35	32.5	6	1.2	5	44	57	15	KM7	1.04
MB8	40	37.5	6	1.2	6	50	62	15	KM8	1.23
MB9	45	42.5	6	1.2	6	56	69	17	KM9	1.52
MB10	50	47.5	6	1.2	6	61	74	17	KM10	1.60
MB11	55	52.5	8	1.2	7	67	81	17	KM11	1.96
MB12	60	57.5	8	1.5	7	73	86	17	KM12	2.53
MB13	65	62.5	8	1.5	7	79	92	19	KM13	2.90
MB14	70	66.5	8	1.5	8	85	98	19	KM14	3.34
MB15	75	71.5	8	1.5	8	90	104	19	KM15	3.56
MB16	80	76.5	10	1.8	8	95	112	19	KM16	4.64
MB17	85	81.5	10	1.8	8	102	119	19	KM17	5.24
MB18	90	86.5	10	1.8	10	108	126	19	KM18	6.23
MB19	95	91.5	10	1.8	10	113	133	19	KM19	6.70
MB20	100	96.5	12	1.8	10	120	142	19	KM20	7.65
MB21	105	100.5	12	1.8	12	126	145	19	KM21	8.26
MB22	110	105.5	12	1.8	12	133	154	19	KM22	9.40
MB23	115	110.5	12	2	12	137	159	19	KM23	10.80
MB24	120	115	14	2	12	138	164	19	KM24	10.50
MB25	125	120	14	2	12	148	170	19	KM25	11.80
MB26	130	125	14	2	12	149	175	19	KM26	11.30
MB27	135	130	14	2	14	160	185	19	KM27	14.40
MB28	140	135	16	2	14	160	192	19	KM28	14.20
MB29	145	140	16	2	14	172	202	19	KM29	16.80
MB30	150	145	16	2	14	171	205	19	KM30	15.50
MB31	155	147.5	16	2.5	16	182	212	19	KM31	20.90
MB32	160	154	18	2.5	16	182	217	19	KM32	22.20
MB33	165	157.5	18	2.5	16	193	222	19	KM33	24.10
MB34	170	164	18	2.5	16	193	232	19	KM34	24.70
MB36	180	174	20	2.5	18	203	242	19	KM36	26.80
MB38	190	184	20	2.5	18	214	252	19	KM38	27.80
MB40	200	194	20	2.5	18	226	262	19	KM40	29.30