

Self-Aligning Ball Bearings

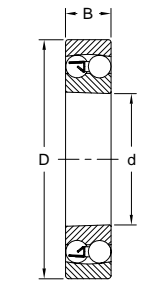

Tapered & Straight Bores 1200 & 1300 Series



Tapered Bore

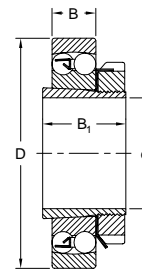

Tapered Bore Adapter Mounted
Uses H200 Adapters
or SNW Series

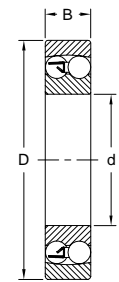

Straight Bore

1200 and 1200 K Series

| Straight Bore Bearing Part No. * | Taper Bore Bearing Part No. * | Dimensions (mm) | | | | | | | Basic Load Ratings in kN | | Max. rpm | | Weight kg | |
|---|--|-----------------|-----|----|-----|------------------|----------------|----------------|-----------------------------|----------------|----------|-------|--------------|--------|
| | | d | D | B | r | d ₁ * | | B ₁ | Dynamic | Static | Grease | Oil | Bearing | Sleeve |
| | | | | | | mm | in | | C | C ₀ | | | | |
| 1205 | 1205K | 25 | 52 | 15 | 1.0 | 20 | 5/8, 3/4 | 26 | 12.2 | 3.35 | 13000 | 16000 | 0.1 | 0.1 |
| 1206 | 1206K | 30 | 62 | 16 | 1.0 | 25 | 7/8, 1 | 27 | 15.6 | 4.65 | 11000 | 14000 | 0.2 | 0.1 |
| 1207 | 1207K | 35 | 72 | 17 | 1.1 | 30 | 1-1/8, 1-3/16 | 29 | 16.0 | 5.20 | 9500 | 12000 | 0.3 | 0.1 |
| 1208 | 1208K | 40 | 80 | 18 | 1.1 | 35 | 1-1/4, 1-3/8 | 31 | 19.3 | 6.55 | 8500 | 10000 | 0.4 | 0.2 |
| 1209 | 1209K | 45 | 85 | 19 | 1.1 | 40 | 1-1/2 | 33 | 22.0 | 7.35 | 7500 | 9000 | 0.5 | 0.2 |
| 1210 | 1210K | 50 | 90 | 20 | 1.1 | 45 | 1-11/16, 1-3/4 | 35 | 22.8 | 8.15 | 7000 | 8500 | 0.5 | 0.3 |
| 1211 | 1211K | 55 | 100 | 21 | 1.5 | 50 | 1-15/16, 2 | 37 | 27.0 | 10.0 | 6300 | 7500 | 0.7 | 0.3 |
| 1212 | 1212K | 60 | 110 | 22 | 1.5 | 55 | 2-1/8, 2-3/16 | 38 | 30.0 | 11.6 | 5600 | 6700 | 0.9 | 0.3 |
| 1213 | 1213K | 65 | 120 | 23 | 1.5 | 60 | 2-1/4 | 40 | 31.0 | 12.5 | 5300 | 6300 | 1.2 | 0.4 |
| 1214 | 1214K | 70 | 125 | 24 | 1.5 | — | — | — | 34.5 | 13.7 | 5000 | 6000 | 1.3 | — |
| 1215 | 1215K | 75 | 130 | 25 | 1.5 | 65 | 2-7/16, 2-1/2 | 43 | 39.0 | 15.6 | 4800 | 5600 | 1.4 | 0.7 |
| 1216 | 1216K | 80 | 140 | 26 | 2.0 | 70 | 2-11/16, 2-3/4 | 46 | 40.0 | 17.0 | 4300 | 5000 | 1.7 | 0.9 |
| 1217 | 1217K | 85 | 150 | 28 | 2.0 | 75 | 2-15/16, 3 | 50 | 49.0 | 20.4 | 4000 | 4800 | 2.1 | 1.0 |
| 1218 | 1218K | 90 | 160 | 30 | 2.0 | 80 | 3-3/16, 3-1/4 | 52 | 57.0 | 23.6 | 3800 | 4500 | 2.6 | 1.2 |
| 1219 | 1219K | 95 | 170 | 32 | 2.1 | 85 | 3-3/8 | 55 | 64.0 | 27.0 | 3400 | 4000 | 3.2 | 1.4 |
| 1220 | 1220K | 100 | 180 | 34 | 2.1 | 90 | 3-7/16, 3-1/2 | 58 | 69.5 | 30.0 | 3200 | 3800 | 3.8 | 1.5 |
| 1222 | 1222K | 110 | 200 | 38 | 2.1 | 100 | 3-15/16, 4 | 63 | 88.0 | 38.0 | 2800 | 3400 | 5.2 | 1.9 |

1300 Series (for Taper Bore see H300 Series Adapters)

| | | | | | | | | | | | | | | |
|------|-------|----|-----|----|-----|----|----------------|----|-------|------|-------|-------|-----|-----|
| 1305 | 1305K | 25 | 62 | 17 | 1.1 | 20 | 5/8, 3/4 | 29 | 18.0 | 5.0 | 11000 | 14000 | 0.3 | 0.1 |
| 1306 | 1306K | 30 | 72 | 19 | 1.1 | 25 | 7/8, 1 | 31 | 21.2 | 6.3 | 9000 | 11000 | 0.4 | 0.1 |
| 1307 | 1307K | 35 | 80 | 21 | 1.5 | 30 | 1-1/8, 1-3/16 | 35 | 25.0 | 8.0 | 8000 | 9500 | 0.5 | 0.1 |
| 1308 | 1308K | 40 | 90 | 23 | 1.5 | 35 | 1-1/4 | 36 | 29.0 | 9.6 | 7000 | 8500 | 0.7 | 0.2 |
| 1309 | 1309K | 45 | 100 | 25 | 1.5 | 40 | 1-1/2 | 39 | 38.0 | 12.9 | 6300 | 7500 | 1.0 | 0.2 |
| 1310 | 1310K | 50 | 110 | 27 | 2.0 | 45 | 1-11/16, 1-3/4 | 42 | 41.5 | 14.3 | 5600 | 6700 | 1.3 | 0.3 |
| 1311 | 1311K | 55 | 120 | 29 | 2.0 | 50 | 1-15/16, 2 | 45 | 51.0 | 18.0 | 5000 | 6000 | 1.6 | 0.3 |
| 1312 | 1312K | 60 | 130 | 31 | 2.1 | 55 | 2-1/8, 2-3/8 | 47 | 57.0 | 20.8 | 4500 | 5300 | 2.0 | 0.4 |
| 1313 | 1313K | 65 | 140 | 33 | 2.1 | 60 | 2-1/4 | 50 | 62.0 | 22.8 | 4300 | 5000 | 2.5 | 0.5 |
| 1314 | — | 70 | 150 | 35 | 2.1 | — | — | — | 75.0 | 27.5 | 4000 | 4800 | 3.1 | — |
| 1315 | 1315K | 75 | 160 | 37 | 2.1 | 65 | 2-7/16, 2-1/2 | 55 | 80.0 | 30.0 | 3600 | 4300 | 3.7 | 0.8 |
| 1316 | 1316K | 80 | 170 | 39 | 2.1 | 70 | 2-11/16, 2-3/4 | 59 | 88.0 | 32.5 | 3400 | 4000 | 4.3 | 1.0 |
| 1317 | 1317K | 85 | 180 | 41 | 3.0 | 75 | 2-15/16, 3 | 63 | 98.0 | 38.0 | 3200 | 3800 | 5.1 | 1.2 |
| 1318 | 1318K | 90 | 190 | 43 | 3.0 | 80 | 3-3/16, 3-1/4 | 65 | 108.0 | 43.0 | 3000 | 3600 | 6.0 | 1.4 |

*Note: Part No. Suffix C3W33 (C3 = Internal Clearance, W33 = Lube Groove) will be provided unless otherwise specified.
K = Taper Bore, without K = straight bore. For Taper Bore (K) bearings, use the H200 Series adapters.

Self-Aligning Ball Bearings



2200 & 2300 Series

Tapered & Straight Bores

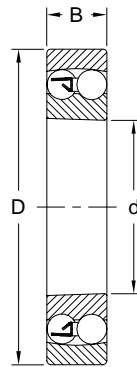

Tapered Bore

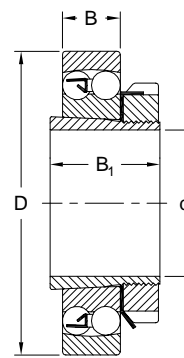

Tapered Bore Adapter Mounted
Uses H200 Adapters
or SNW Series

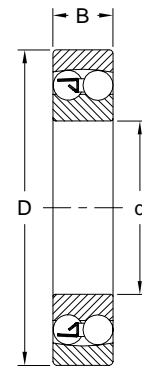

Straight Bore

2200 Series (for Taper Bore see H300 Series Adapters)

| Straight Bore Bearing Part No. * | Taper Bore Bearing Part No. * | Dimensions (mm) | | | | | | | Basic Load Ratings in kN | | Max. rpm | | Weight kg | |
|---|--|-----------------|-----|----|-----|------------------|----------------|----------------|-----------------------------|----------------|----------|-------|--------------|--------|
| | | d | D | B | r | d ₁ * | | B ₁ | C | C ₀ | Grease | Oil | Bearing | Sleeve |
| | | | | | | mm | in | | | | | | | |
| 2205 | 2205K | 25 | 52 | 18 | 1.0 | 20 | 5/8, 3/4 | 29 | 17.0 | 4.4 | 12000 | 15000 | 0.2 | 0.1 |
| 2206 | 2206K | 30 | 62 | 20 | 1.0 | 25 | 7/8, 1 | 31 | 25.5 | 6.9 | 9500 | 12000 | 0.3 | 0.1 |
| 2207 | 2207K | 35 | 72 | 23 | 1.1 | 30 | 1-1/8, 1-3/16 | 35 | 32.0 | 9.0 | 8000 | 9500 | 0.4 | 0.1 |
| 2208 | 2208K | 40 | 80 | 23 | 1.1 | 35 | 1-1/4 | 36 | 31.5 | 9.5 | 7500 | 9000 | 0.5 | 0.2 |
| 2209 | 2209K | 45 | 85 | 23 | 1.1 | 40 | 1-1/2 | 39 | 28.0 | 9.0 | 7000 | 8500 | 0.5 | 0.2 |
| 2210 | 2210K | 50 | 90 | 23 | 1.1 | 45 | 1-11/16, 1-3/4 | 42 | 28.0 | 9.5 | 6700 | 8000 | 0.6 | 0.3 |
| 2211 | 2211K | 55 | 100 | 25 | 1.5 | 50 | 1-15/16, 2 | 45 | 39.0 | 12.7 | 5600 | 6700 | 0.8 | 0.3 |
| 2212 | 2212K | 60 | 110 | 28 | 1.5 | 55 | 2-1/8, 2-3/8 | 47 | 47.5 | 16.6 | 5300 | 6300 | 1.1 | 0.4 |
| 2213 | 2213K | 65 | 120 | 31 | 1.5 | 60 | 2-1/4 | 50 | 57.0 | 19.3 | 4500 | 5300 | 1.4 | 0.5 |
| 2214 | — | 70 | 125 | 31 | 1.5 | — | — | — | 44.0 | 17.0 | 4800 | 5600 | 1.6 | — |
| 2215 | 2215K | 75 | 130 | 31 | 1.5 | 65 | 2-7/16, 2-1/2 | 55 | 44.0 | 18.0 | 4500 | 5300 | 1.7 | 0.9 |
| 2216 | 2216K | 80 | 140 | 33 | 2.0 | 70 | 2-11/16, 2-3/4 | 59 | 51.0 | 21.2 | 4300 | 5000 | 2.1 | 1.0 |
| 2217 | 2217K | 85 | 150 | 36 | 2.0 | 75 | 2-15/16, 3 | 63 | 58.5 | 23.6 | 4000 | 4800 | 2.6 | 1.2 |
| 2218 | 2218K | 90 | 160 | 40 | 2.0 | 80 | 3-3/16, 3-1/4 | 65 | 71.0 | 28.5 | 3600 | 4300 | 3.3 | 1.4 |
| 2220 | 2220K | 100 | 180 | 46 | 2.1 | 90 | — | 71 | 98.0 | 40.5 | 3200 | 3800 | 5.2 | 1.7 |
| 2222 | 2222K | 110 | 200 | 53 | 2.1 | 100 | — | 77 | 124.0 | 52.0 | 2800 | 3400 | 7.1 | 2.2 |

2300 Series (for Taper Bore see H2300 Series Adapters)

| | | | | | | | | | | | | | | |
|------|-------|----|-----|----|-----|----|----------------|----|-------|------|-------|-------|-----|-----|
| 2305 | 2305K | 25 | 62 | 24 | 1.1 | 20 | 5/8, 3/4 | 35 | 24.5 | 6.5 | 10000 | 13000 | 0.4 | 0.1 |
| 2306 | 2306K | 30 | 72 | 27 | 1.1 | 25 | 7/8, 1 | 38 | 31.5 | 8.6 | 8500 | 10000 | 0.6 | 0.1 |
| 2307 | 2307K | 35 | 80 | 31 | 1.5 | 30 | 1-1/8, 1-3/16 | 43 | 39.0 | 11.2 | 7500 | 9000 | 0.7 | 0.2 |
| 2308 | 2308K | 40 | 90 | 33 | 1.5 | 35 | 1-1/4 | 46 | 45.0 | 13.4 | 6700 | 8000 | 1.0 | 0.2 |
| 2309 | 2309K | 45 | 100 | 36 | 1.5 | 40 | 1-1/2 | 50 | 54.0 | 16.3 | 6000 | 7000 | 1.3 | 0.3 |
| 2310 | 2310K | 50 | 110 | 40 | 2.0 | 45 | 1-11/16, 1-3/4 | 55 | 64.0 | 20.0 | 5300 | 6300 | 1.8 | 0.4 |
| 2311 | 2311K | 55 | 120 | 43 | 2.0 | 50 | 1-15/16, 2 | 59 | 75.0 | 23.6 | 4800 | 5600 | 2.3 | 0.4 |
| 2312 | 2312K | 60 | 130 | 46 | 2.1 | 55 | 2-1/8, 2-3/8 | 62 | 86.5 | 28.0 | 4300 | 5000 | 2.8 | 0.5 |
| 2313 | 2313K | 65 | 140 | 48 | 2.1 | 60 | 2-1/4 | 65 | 95.0 | 32.5 | 4000 | 4800 | 3.4 | 0.6 |
| 2314 | — | 70 | 150 | 51 | 2.1 | — | — | — | 110.0 | 37.5 | 3600 | 4300 | 4.2 | — |
| 2315 | 2315K | 75 | 160 | 55 | 2.1 | 65 | 2-7/16, 2-1/2 | 73 | 122.0 | 42.5 | 3400 | 4000 | 5.2 | 1.1 |
| 2316 | 2316K | 80 | 170 | 58 | 2.1 | 70 | 2-11/16, 2-3/4 | 78 | 137.0 | 48.0 | 3200 | 3800 | 6.4 | 1.3 |
| 2317 | 2317K | 85 | 180 | 60 | 3.0 | 75 | 2-15/16, 3 | 82 | 140.0 | 51.0 | 3000 | 3600 | 7.5 | 1.5 |
| 2318 | 2318K | 90 | 190 | 64 | 3.0 | 80 | 3-3/16, 3-1/4 | 86 | 153.0 | 57.0 | 2800 | 3400 | 8.9 | 1.7 |

*Note: Part No. Suffix C3W33 (C3 = Internal Clearance, W33 = Lube Groove) will be provided unless otherwise specified.

K = Taper Bore, without K = straight bore. For Taper Bore (K) bearings, use the H300 or H2300 Series adapters.