

Metric Double Single Sprocket

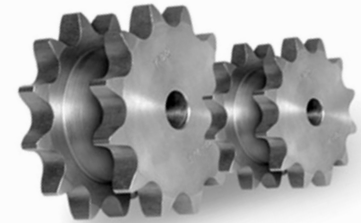

Material: C45 E Steel

For 06B-1 Roller Chain (3/8" x 7/32", Roller Diameter 6.35mm)						
Part No.	Teeth	h2	F	F1	Db	D
06B-13DS	13	24.3	19	13.7	28	10
06B-14DS	14	24.3	19	13.7	31	10
06B-15DS	15	24.3	19	13.7	34	10
06B-16DS	16	24.3	19	13.7	37	10
06B-17DS	17	24.3	19	13.7	40	10
06B-18DS	18	24.3	19	13.7	43	10
06B-19DS	19	24.3	19	13.7	46	10
06B-20DS	20	24.3	19	13.7	49	10
06B-21DS	21	24.3	19	13.7	52	12
06B-23DS	23	24.3	19	13.7	59	12
06B-25DS	25	24.3	19	13.7	65	12

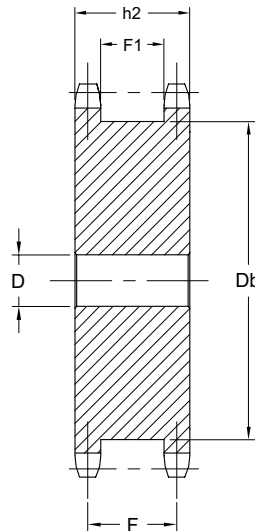

For 08B-1 Roller Chain (1/2" x 5/16", Roller Diameter 8.51mm)						
Part No.	Teeth	h2	F	F1	Db	D
08B-12DS	12	31	23.8	16.6	33	10
08B-13DS	13	31	23.8	16.6	37	10
08B-14DS	14	31	23.8	16.6	42	10
08B-15DS	15	31	23.8	16.6	45	10
08B-16DS	16	31	23.8	16.6	49	10
08B-17DS	17	31	23.8	16.6	53	12
08B-18DS	18	31	23.8	16.6	57	12
08B-19DS	19	31	23.8	16.6	62	12
08B-20DS	20	31	23.8	16.6	66	12
08B-21DS	21	31	23.8	16.6	70	14
08B-23DS	23	31	23.8	16.6	78	14
08B-24DS	24	31	23.8	16.6	82	14
08B-25DS	25	31	23.8	16.6	86	14

For 10B-1 Roller Chain (5/8" x 3/8", Roller Diameter 10.16mm)						
Part No.	Teeth	h2	F	F1	Db	D
10B-12DS	12	36.5	27.3	18.1	45	12
10B-13DS	13	36.5	27.3	18.1	50	12
10B-14DS	14	36.5	27.3	18.1	55	12
10B-15DS	15	36.5	27.3	18.1	60	12
10B-16DS	16	36.5	27.3	18.1	73	14
10B-17DS	17	36.5	27.3	18.1	70	14
10B-18DS	18	36.5	27.3	18.1	75	14
10B-19DS	19	36.5	27.3	18.1	80	14
10B-20DS	20	36.5	27.3	18.1	85	14
10B-21DS	21	36.5	27.3	18.1	90	16
10B-22DS	22	36.5	27.3	18.1	95	16
10B-23DS	23	36.5	27.3	18.1	100	16
10B-25DS	25	36.5	27.3	18.1	110	16

For 12B-1 Roller Chain (3/4" x 7/16", Roller Diameter 12.07mm)						
Part No.	Teeth	h2	F	F1	Db	D
12B-12DS	12	45	33.9	22.8	53	14
12B-13DS	13	45	33.9	22.8	59	14
12B-14DS	14	45	33.9	22.8	65	14
12B-15DS	15	45	33.9	22.8	71	14
12B-16DS	16	45	33.9	22.8	77	14
12B-17DS	17	45	33.9	22.8	83	16
12B-18DS	18	45	33.9	22.8	89	16
12B-19DS	19	45	33.9	22.8	95	16
12B-20DS	20	45	33.9	22.8	101	16
12B-21DS	21	45	33.9	22.8	107	20
12B-23DS	23	45	33.9	22.8	119	20
12B-25DS	25	45	33.9	22.8	131	20

For 16B-1 Roller Chain (1" x 17.02", Roller Diameter 15.88mm)						
Part No.	Teeth	h2	F	F1	Db	D
16B-13DS	13	63.5	47.3	31.1	81	16
16B-14DS	14	63.5	47.3	31.1	89	16
16B-15DS	15	63.5	47.3	31.1	97	16
16B-16DS	16	63.5	47.3	31.1	105	20
16B-17DS	17	63.5	47.3	31.1	113	20
16B-18DS	18	63.5	47.3	31.1	121	20
16B-19DS	19	63.5	47.3	31.1	129	20
16B-20DS	20	63.5	47.3	31.1	137	20
16B-21DS	21	63.5	47.3	31.1	145	20
16B-23DS	23	63.5	47.3	31.1	161	20
16B-25DS	25	63.5	47.3	31.1	177	20

Note: TL Taper Bushed version available on request.

Finished Bore also available on request.